

**East Thames Housing / Epping Forest District Council  
Housing Delivery Programme**

**Feasibility Report**

**Site: 12-36 Bourne House (Garages), Buckhurst Hill, IG9 6JY**

**Rev: A**

## Contents

---

1. Introduction and Confirmation of Brief
2. Existing Site and Surroundings
3. Proposals
4. Planning Issues and Risks
5. Impact/Implications of Statutory Services
6. Site Access and Buildability Issues
7. Neighbourly Matters and Party Walls
8. Proposed Procurement Route
9. Impact on Parking
10. Legals
11. Costs
12. Recommendations and Conclusions

## Appendices

- A: Development Proposals – Drawings 612.023/P2-4A
- B: Site Photographs
- C: Existing Site Plan 201206014-AA
- D: Statutory Services Information
- E: Information on Possible Contamination
- F: Cost Build-up

## 1.0 Introduction and Confirmation of Brief

- 1.1. Pellings LLP are appointed as part of East Thames Group Technical Team in respect of delivery of Development Agent services to Epping Forest District Council for a six year housing delivery programme.
- 1.2. Following initial appraisal by EFDC, 59 sites have been identified as having possible development potential, with a further number of sites in reserve.
- 1.3. Pellings LLP have been instructed to progress feasibility studies to all 59 sites and which will assist in establishing the extent and timing of the overall programme.
- 1.4. Our instructions are in accordance with our fee tender of 13 August 2012, against the previously prepared tender documentation, and email confirmation of 9 April 2013.

## 2.0 Existing Site and Surroundings

- 2.1. The site is located on the eastern side of Buckhurst Hill in a residential area comprising houses and flats approximately half a mile south of Buckhurst Hill station.
- 2.2. The site consists of 25 garages and hardstanding and it is accessed by way of a 3.5m driveway between properties on Hornbeam Road. The site is situated at the rear of nos. 54-60 Hornbeam Road which are within a two storey building with a rear garden. The adjoining sites are also residential, including Bourne House, which is a four storey block of flats. The site adjoins a sports ground to the rear (i.e. east).
- 2.3. There are a number of mature trees either on or close to the site.

## 3.0 Proposals

- 3.1. Read in conjunction with drawings 612.023.P2-4A attached at Appendix A.
- 3.2. The proposals are :

2 x 3 bed houses, 2 storey  
Provision of 7 parking spaces and garden/landscaped areas

## 4.0 Planning Issues and Risks

### *Relevant Planning Policies/Considerations*

- 4.1. The adopted Development Plan for Epping Forest District Council is the Combined Local Plan 1998 and Local Plan Alterations 2006.
- 4.2. The site is not located in a Conservation Area it is not designated for any particular purposes in the Epping Forest District Council Combined Local Plan 1998 and Local Plan Alterations 2006. The site does not lie in Flood Zone on the Environment Agency Flood Map.
- 4.3. There are no specific policies which prevent the loss of existing garages although policy ST4 (Road Safety) states that planning permission will only be granted where there will be no adverse effects on the highway, traffic congestion or harm to the character or appearance of the area. Parking spaces to meet with the Council's standards are proposed for the new dwellings.

- 4.4. It will be necessary to undertake a Parking Survey and to prepare a Transport Statement to demonstrate that the loss of the garages and proposed development would not cause any parking shortfalls or harm to highway conditions or the amenities of the area.
- 4.5. The site is located in the settlement of Buckhurst Hill and the proposal would be consistent with policy CP7 which encourages the efficient use of existing built-up areas by the 'recycling of vacant, derelict, degraded and under-used land to accommodate the development' and the 're-use of urban sites, which are no longer appropriate to their existing or proposed use in the foreseeable future, for alternative land uses'.
- 4.6. The proposal would comply with policy H4A which states the need for a range of dwellings, including an appropriate proportion of smaller dwellings, to meet identified housing need on a site-by-site basis.
- 4.7. The development of small family homes with rear gardens and private and communal parking would be in keeping with the character and appearance of the area and may comply with Epping Forest's design policies and guidance.

## 5.0 **Impact/Implications of Statutory Services**

5.1. We have undertaken statutory services enquiries to the following:

- Southern Gas
- Cable and Wireless
- Virgin Media
- Thames Water
- BT
- National Grid
- Scottish and Southern Energy
- Environment Agency
- UK Power Networks

5.2. Responses received to date are from the Environment Agency, National Grid, UK Power Networks, Virgin Media and Thames Water.

5.3. The Environment Agency do not note any significant constraints but recommend measures to achieve water efficiency and the use of Sustainable Urban Drainage systems.

5.3.1. National Grid: No apparatus appears to cross the site

5.3.2. UK Power Networks: No apparatus appears to cross the site

5.3.3. Virgin Media: No apparatus appears to cross the site

5.4. Thames Water: No apparatus appears to cross the site

5.5. It should be noted there are a number of responses to enquiries that, at time of preparation of this report, have not yet been received.

## 6.0 **Site Access and Buildability Issues**

6.1. The site is accessed from existing site roads and there would not appear to be any particular difficulties for the normal level and size of construction traffic associated with a development of this nature.

- 6.2. Areas should be available for contractor's site set up and accommodation.
- 6.3. The site is within a primarily residential area and, accordingly, any appointed contractor should use all best endeavours to act in a considerate manner and within normal working hours.
- 6.4. Further to initial enquiries made to EFDC, some potential contamination issues have been highlighted with use of the domestic garages, and also a former horticultural nursery. Possible contaminants in respect of the former use as a nursery are summarised and indicated within the note produced by EFDC Planning and Economic Development Directorate at Appendix E.
- 6.5. Possible contaminants in respect of the previous use of the garage site may include asbestos, ash and clinker, hydro-carbons from vehicle maintenance and the like.
- 6.6. Accordingly, suitable site investigation will need to be undertaken ahead of any proposals to take this site forward and specific recommendations made to deal with any contamination found, whether by capping or removal from site.
- 6.7. The site is accessed by way of a narrow driveway and as at present, our proposals do not include a turning head for refuse or emergency vehicles. Accordingly, subject to detailed design, an independent refuse storage area may be required along with sprinkler provision to the new houses for fire protection.

## 7.0 **Neighbourly Matters and Party Walls**

- 7.1. As above, the proposed development site is within a primarily residential area and the appointed contractor should act in a considerate manner. It is proposed that restrictions on working hours, noise levels, requirement for resident liaison and similar matters will be included within contract documentation.
- 7.2. From proposals on Drawing 612.023/P2-4A, it is not considered that Party Wall matters will be relevant.

## 8.0 **Proposed Procurement Route**

- 8.1. It is understood that development works will be procured by way of the East Thames Housing Group existing contractor framework arrangements.
- 8.2. It is proposed that works shall be procured on a Design and Build basis with the contractors taking forward RIBA Stage D planning consent drawings into detailed design and construction delivery on site.
- 8.3. Schemes shall be designed to a set of Employer's Requirements to be subsequently confirmed but which substantially shall be formed from existing East Thames Housing Group Design Standards and Employer's Requirement documentation.
- 8.4. It is proposed that all site preparation works will be included within individual contract packages including any required demolitions, adjustment of statutory services, highways works and boundary maintenance/reinstatement/provision.

- 8.5. On completion of the feasibility studies for the whole programme, further recommendations will be made in terms of how works are packaged to ensure size of work packages are optimised for ensuring maximum economies for East Thames Housing Group and EFDC.
- 8.6. It is considered, at this stage, that this may be by way of a mix of different sized contractors dependent upon the numbers and geographical location of individual works packages.
- 8.7. Works will be administered by Pellings LLP as Employer's Agent acting in accordance with East Thames Housing Group terms of appointment and the overarching requirements of the Development Agency agreement.

## 9.0 **Impact on Parking**

- 9.1. The Council's currently adopted parking standards are contained within Essex County Council's Parking Standards Design and Good Practice Guide – September 2009. These revised standards were adopted by the Council as statutory planning guidance in February 2012.
- 9.2. Flats and houses have the same parking standard as follows:
- 1 bedroom accommodation – 1 space per dwelling
  - 2 bedroom accommodation and above – 2 spaces per dwelling
  - Visitor parking – 0.25 spaces per dwelling (rounded up to the nearest whole number)
- 9.3. The proposals would appear to more than meet the Council's parking standards for new development.
- 9.4. However, should the site move forward to planning application stages, it is recommended that a Transport Statement be undertaken, including parking surveys, to demonstrate that the loss of the garages will not give rise to any planning or highway problems.

## 10.0 **Legals**

- 10.1. We have been provided with a Summary Report of legal matters from EFDC Solicitors. The report makes reference to the suggested appropriation of land for planning purposes which would extinguish any prior rights of way.
- 10.2. The report makes reference to possible rights of light risk. A blanket policy against such risk might be considered.
- 10.3. There is a possible right of way for Estuary Housing Association over the corner of the site (access from Newton Court). This would appear to be unaffected by proposals however.

## 11.0 **Costs**

- 11.1. It is considered that a budget of £427,500.00 should be allowed for this scheme, inclusive of contractor design fees, but exclusive of professional fees and VAT. Please refer to Appendix F.

12.0 **Recommendations and Conclusions**

12.1. Subject to an overall lifetime cost appraisal, we conclude that the site appears to have economic development opportunities and we recommend is considered for taking forward to planning application stage, with a view to incorporating into the overall programme.

Signed:  ..... Date: 1<sup>st</sup> October 2014  
Pellings/LLP

# Appendix A

Development Proposals

Drawings 612.023.P2-4A





**TOTALS**  
 Site Area 0.064 Ha  
 2 x 3 Bed Houses @ 93 sqm  
 7 Parking Spaces

**NOTES:**  
 Report all discrepancies, errors and omissions  
 Do not scale from this drawing.  
 Verify all dimensions on site before commencing any work or preparing shop drawings.  
 All materials, components and workmanship are to comply with all the relevant British Standards, Codes of Practice, and appropriate manufacturers recommendations that from time to time shall apply.  
 For all specialist work, see relevant drawings.  
 This drawing and design are copyright of PELLINGS LLP

**PRELIMINARY**

Rev	Date	Description	Name
-	-/-/-		



Pellings LLP 24 Widmore Road Bromley Kent BR1 1RY t 020 8460 9114 f 020 8313 0019 e bromley@pellings.co.uk www.pellings.co.uk		Architecture & Planning ■ Building Surveying ■ Project Management ■ Cost Consultancy ■ CDM Co-ordination	
CLIENT	East Thames HA	PROJECT	EFDC House Building Programme
TITLE	Existing and Proposed Plans Bourne House	DATE	NOV 2013
		SCALE	1:500 @A3
		DRAWN	NP
		CHK	
DRAWING No		612 023 P2-4   A	

## Appendix B

### Site Photographs

## Appendix B - Site Photographs

1.



2.



3.



4.



5.



6.



## Appendix C

Existing Site Plan

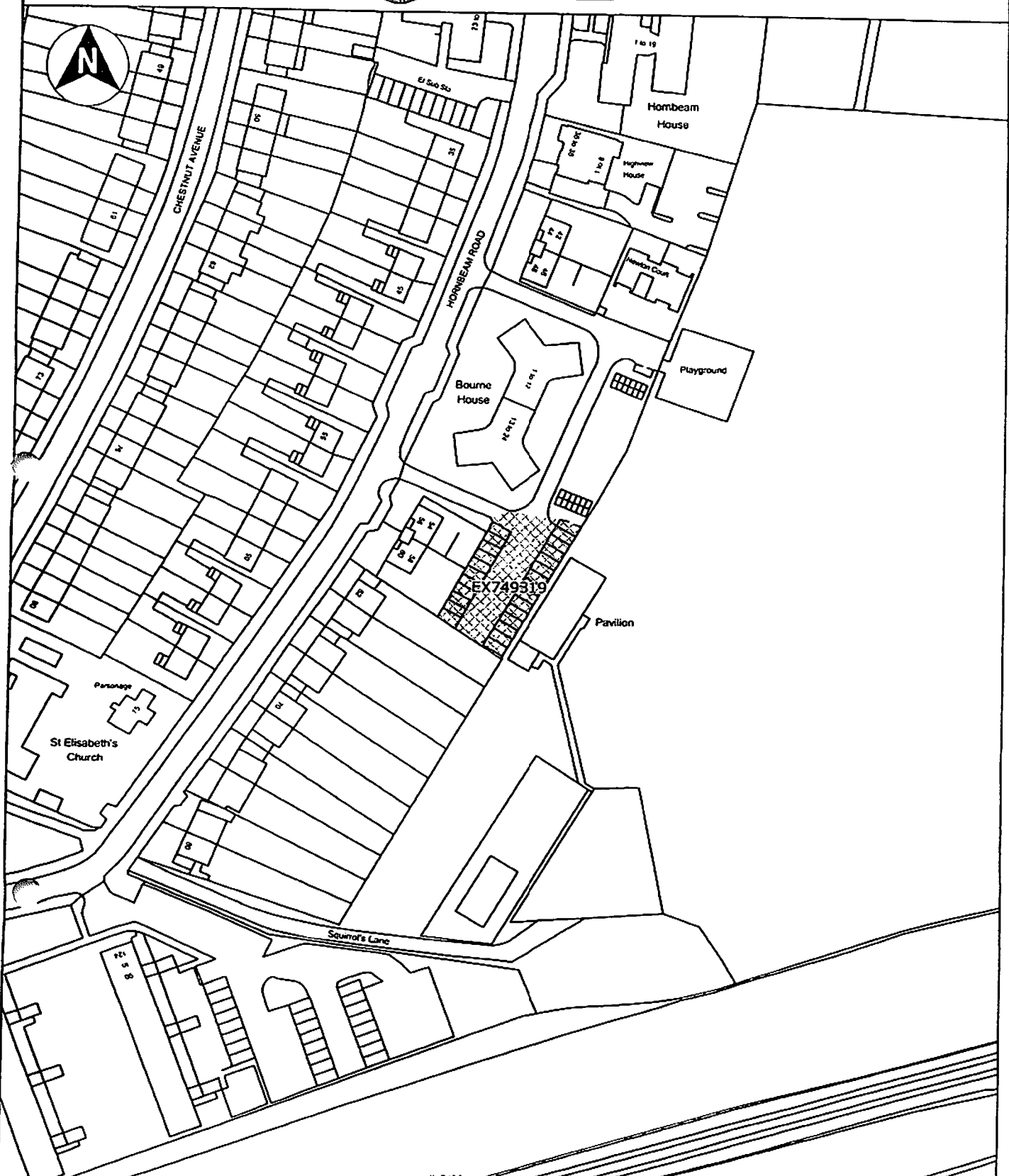

Contains Ordnance Survey & Royal Mail Data  
 © Crown Copyright & Database Right 2011  
 EFDC License No: 100018534 2011

Directorate of Environment & Street Scene  
 Civic Offices  
 High Street  
 Epping, Essex,  
 CM16 4BZ  
 Tel. 01992 564000

**Project**  
 Potential Site for Council House  
 Building Program

**Drawing No.**  
 201206014 - A

**Content**  
 Bourne House  
 Hornbeam Road  
 Buckhurst Hill

**Date**  
 04/07/12

**Scale**  
 1:1250 @ A4

**Drawn By**  
 Robert Irwin

## Appendix D

Statutory Services Information





Adam Greenhalgh  
Pellings  
24 Widmore Road  
Bromley  
Kent  
BR1 1RY

Plant Protection  
National Grid  
Block 1; Floor 1  
Brick Kiln Street  
Hinckley  
LE10 0NA  
E-mail: [plantprotection@nationalgrid.com](mailto:plantprotection@nationalgrid.com)  
Telephone: +44 (0)800 688588

National Grid Electricity Emergency Number:  
0800 40 40 90\*

National Gas Emergency Number:  
0800 111 999\*

\* Available 24 hours, 7 days/week.  
Calls may be recorded and monitored.

[www.nationalgrid.com](http://www.nationalgrid.com)

**Date:** 23/10/2013  
**Our Ref:** NL\_TE\_Z6\_3SW\_041948  
**Your Ref:** Bourne House. Ia079

**RE: Proposed Works, IG9 6JY, Bourne house, Hornbeam Road, Buckhurst Hill**

Thank you for your enquiry which was received on 17/10/2013.

Please note this response and any attached map(s) are valid for 28 days.

An assessment has been carried out with respect to National Grid Electricity Transmission plc's and National Grid Gas plc's apparatus. Please note it does not cover the items listed in the section "Your Responsibilities and Obligations", including gas service pipes and related apparatus.

For details of National Grid's network areas please see the National Grid website (<http://www.nationalgrid.com/uk/Gas/Safety/work/>) or the enclosed documentation.

**As your works are at a "proposed" stage, any maps and guidance provided are for information purposes only. This is not approval to commence work. You must submit a "Scheduled Works" enquiry at the earliest opportunity and failure to do this may lead to disruption to your plans and works. National Grid will endeavour to provide an initial assessment within 14 days of receipt of a Scheduled Works enquiry and dependent on the outcome of this, further consultation may be required.**

**In any event, for safety and legal reasons, works must not be carried out until a Scheduled Works enquiry has been completed and final response received.**

## Your Responsibilities and Obligations

The "Assessment" Section below outlines the detailed requirements that must be followed when planning or undertaking your scheduled activities at this location.

It is your responsibility to ensure that the information you have submitted is accurate and that all relevant documents including links are provided to all persons (either direct labour or contractors) working for you near National Grid's apparatus, e.g. as contained within the Construction (Design and Management) Regulations.

This assessment solely relates to National Grid Electricity Transmission plc (NGET) and National Grid Gas plc (NGG) apparatus. This assessment does **NOT** include:

- National Grid's legal interest (easements or wayleaves) in the land which restricts activity in proximity to National Grid's assets in private land. You must obtain details of any such restrictions from the landowner in the first instance and if in doubt contact National Grid.
- Gas service pipes and related apparatus
- Recently installed apparatus
- Apparatus owned by other organisations, e.g. other gas distribution operators, local electricity companies, other utilities, etc.

It is **YOUR** responsibility to take into account whether the items listed above may be present and if they could be affected by your proposed activities. Further "Essential Guidance" in respect of these items can be found on the National Grid Website (<http://www.nationalgrid.com/NR/rdonlyres/6D6525F9-59EB-4825-BA89-DBD7E68882C7/51319/EssentialGuidance.pdf>).

This communication does not constitute any formal agreement or consent for any proposed development work; either generally or with regard to National Grid's easements or wayleaves nor any planning or building regulations applications.

NGG and NGET or their agents, servants or contractors do not accept any liability for any losses arising under or in connection with this information. This limit on liability applies to all and any claims in contract, tort (including negligence), misrepresentation (excluding fraudulent misrepresentation), breach of statutory duty or otherwise. This limit on liability does not exclude or restrict liability where prohibited by the law nor does it supersede the express terms of any related agreements.

If you require further assistance please contact the National Grid Plant Protection team via e-mail ([click here](#)) or via the contact details at the top of this response.

Yours faithfully

National Grid Plant Protection Team

# ASSESSMENT

## Affected Apparatus

The National Grid apparatus that has been identified as being in the vicinity of your proposed works is:

- Low or Medium pressure (below 2 bar) gas pipes and associated equipment. (As a result it is highly likely that there are gas services and associated apparatus in the vicinity)

## Requirements

**BEFORE carrying out any work you must:**

- Carefully read these requirements including the attached guidance documents and maps showing the location of National Grid apparatus.
- Contact the landowner and ensure any proposed works in private land do not infringe National Grid's legal rights (i.e. easements or wayleaves). If the works are in the road or footpath the relevant local authority should be contacted.
- Ensure that all persons, including direct labour and contractors, working for you on or near National Grid's apparatus follow the requirements of the HSE Guidance Notes HSG47 - 'Avoiding Danger from Underground Services' and GS6 – 'Avoidance of danger from overhead electric power lines'. This guidance can be downloaded free of charge at <http://www.hse.gov.uk>
- In line with the above guidance, verify and establish the actual position of mains, pipes, cables, services and other apparatus on site before any activities are undertaken.

# GUIDANCE

**Excavating Safely - Avoiding injury when working near gas pipes:**

[http://www.nationalgrid.com/NR/rdonlyres/2D2EEA97-B213-459C-9A26-18361C6E0B0D/25249/Digsafe\\_leaflet3e2finalamends061207.pdf](http://www.nationalgrid.com/NR/rdonlyres/2D2EEA97-B213-459C-9A26-18361C6E0B0D/25249/Digsafe_leaflet3e2finalamends061207.pdf)

## Standard Guidance

**Essential Guidance document:**

<http://www.nationalgrid.com/NR/rdonlyres/6D6525F9-59EB-4825-BA89-DBD7E68882C7/51319/EssentialGuidance.pdf>

**General Guidance document:**

<http://www.nationalgrid.com/NR/rdonlyres/55C13C4D-A1AA-4B13-BFDA-1CF59F88B326/51318/GeneralGuidance.pdf>

**Excavating Safely in the vicinity of gas pipes guidance (Credit card):**

<http://www.nationalgrid.com/NR/rdonlyres/A3D37677-6641-476C-9DDA-E89949052829/44257/ExcavatingSafelyCreditCard.pdf>

**Excavating Safely in the vicinity of electricity cables guidance (Credit card):**

<http://www.nationalgrid.com/NR/rdonlyres/35DDEC6D-D754-4BA5-AF3C-D607D05A25C2/44858/ExcavatingSafelyCreditCardelectricitycables.pdf>

Copies of all the Guidance Documents can also be downloaded from the National Grid Website:

<http://www.nationalgrid.com/uk/Gas/Safety/work/downloads/>

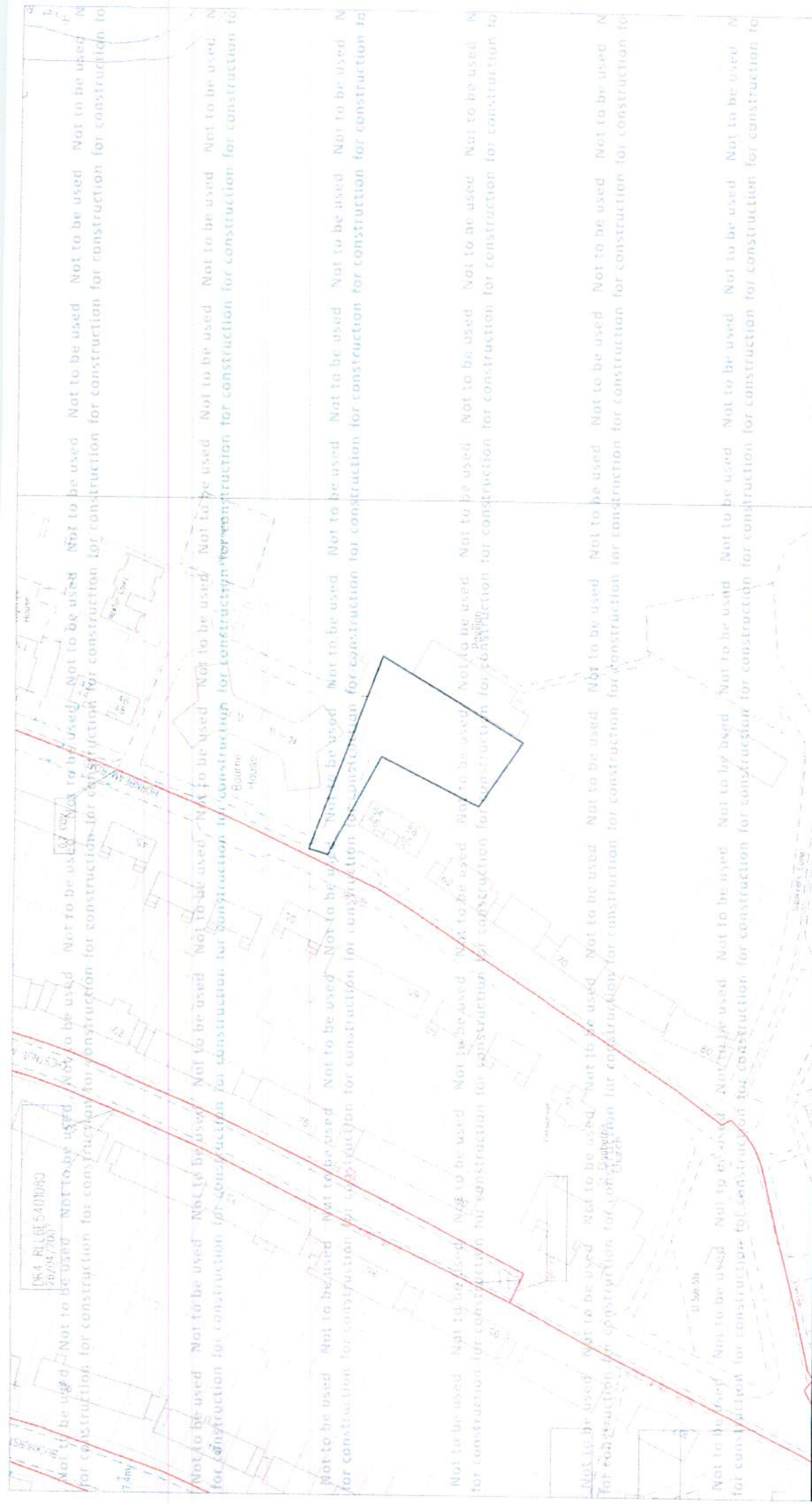

<b>ID: NL_TE_Z6_3SW_041948</b> View extent: 361m, 196m	
<b>USER: laura.altenhofen</b>	<b>Map not to be used for construction</b>
<b>DATE: 23/10/2013</b>	This plan shows those pipes owned by National Grid Gas plc in its role as a Licensed Gas Transporter (GT). Gas pipes owned by other GTs, or otherwise privately owned, may be present in this area. Information with regard to such pipes should be obtained from the relevant owners. The information shown on this plan is given without warranty, the accuracy thereof cannot be guaranteed. Service pipes, valves, syphons, stub connections, etc., are not shown but their presence should be anticipated. No liability of any kind whatsoever is accepted by National Grid Gas plc or their agents, servants or contractors for any error or omission. Safe digging practices, in accordance with HS(G47), must be used to verify and establish the actual position of mains, pipes, services and other apparatus on site before any mechanical plant is used. It is your responsibility to ensure that this information is provided to all persons (either direct labour or contractors) working for you on or near gas apparatus. The information included on this plan should not be referred to beyond a period of 28 days from the date of issue.
<b>DATA DATE: 15/10/2013</b>	
<b>REF: Bourne House. Ia079</b>	
<b>MAP REF: TQ4193</b> <b>CENTRE: 541938, 193154</b>	
	<b>nationalgrid</b> Requested by: Pellings This plan is reproduced from or based on the OS map by National Grid Gas plc, with the sanction of the controller of HM Stationery Office. Crown Copyright Reserved. Ordnance Survey Licence number 100024886

# ENQUIRY SUMMARY

## Received Date

17/10/2013

## Your Reference

Bourne House. Ia079

## Location

Centre Point: 541938, 193154

X Extent: 49

Y Extent: 52

Postcode: IG9 6JY

Location Description: IG9 6JY, Bourne house, Hombeam Road, Buckhurst Hill

## Map Options

Paper Size: A4

Orientation: LANDSCAPE

Requested Scale: 500

Actual Scale: 1:1250 (GAS)

Real World Extents: 361m x 196m (GAS)

## Recipients

pprsteam@uk.ngrid.com

## Enquirer Details

Organisation Name: Pellings

Contact Name: Adam Greenhalgh

Email Address: bromley@pellings.co.uk

Telephone: 0208 460 9114

Address: 24 Widmore Road, Bromley, Kent, BR1 1RY

## Description of Works

Plans request for potential development site.

## Enquiry Type

Proposed Works

## Activity Type

Development Project

## Work Types

Work Type: Plans Only

## Adam Greenhalgh

---

**From:** SPHatfield <SPHatfield@environment-agency.gov.uk>  
**Sent:** 23 October 2013 17:49  
**To:** Adam Greenhalgh  
**Subject:** RE: Epping Forest DC - potential development sites

Dear Adam,

Further to your letters dated 16 October (your ref: AG/dh/612.023/05), we have the following comments to make on the specific sites listed below (please note that comments on three sites – Rear of shops, Loughton Way, Buckhurst Hill; Pentlow Way, Buckhurst Hill and Site B, Marlescroft Way, Loughton – will follow on or before 7 November due to additional site constraints).

**Sites:** Burton Road, Debden  
White Hills, Loughton  
Thatchers Close, Loughton  
Site A, Pyries (note: should be 'Pyrles') Lane, Loughton  
Site B, Pyries (note: should be 'Pyrles') Lane, Loughton  
Site A, Chequers Road, Loughton  
Site B, Chequers Road, Loughton  
Site A, Langley Meadow, Loughton  
Site B, Langley Meadow, Loughton  
Hornbeam Close, Buckhurst Hill  
Hornbeam House, Hornbeam Road, Buckhurst Hill  
Bourne House, Hornbeam Road, Buckhurst Hill  
Bushfields, Loughton  
Etheridge Road, Loughton  
Lower Alderton Hall Lane, Loughton  
Ladyfields, Loughton  
Kirby Close, Loughton  
Chester Road, Loughton  
Hillyfields, Loughton

### Comments

As we are in an area of serious water stress, we endorse the efficient use of water resources. Residential developments such as your proposal should take advantage of water efficient technologies. This is in line with Epping Forest's local policy CP5 which states that the efficient use of water is encouraged through water efficient appliances and rainwater harvesting for example.

We suggest you use water efficiency measures and aim to achieve 105 litres/person/day. This is equivalent to level 3/4 for water within the Code for Sustainable Homes. Achieving this standard within new homes can be accomplished at very little additional cost, and is significantly cheaper than retrofitting such measures later.



Every opportunity should be taken to maximise Sustainable Drainage Systems (SuDS) such as green roofs, ponds, swales and permeable pavements, to alleviate surface water runoff. I have attached a copy of our SuDS guidance, which contains the SuDS hierarchy, to help you with your designs. The methods at the top of the hierarchy are preferred because they are beneficial in terms of sustainability and biodiversity. The hierarchy should be used in descending order. Tanks should only be used as a last resort. Epping Forest's local policy U3B on sustainable drainage systems advocates this approach.

As the sites are all under a hectare in Flood Zone 1, they fall within cell F5 of our Flood Risk Standing Advice consultation matrix. Epping Forest Local Planning Authority will therefore be responsible for assessing flood risk at these sites.

Kind regards,

**Clark Gordon**  
**Sustainable Places Planning Advisor**  
**Environment Agency**  
**North East Thames Area - Hatfield Team**  
01707 632308



The climate is changing. Are you?

A support service led by the Environment Agency  
[www.environment-agency.gov.uk/climateready](http://www.environment-agency.gov.uk/climateready)

please consider the environment - do you really need to print this email?

Information in this message may be confidential and may be legally privileged. If you have received this message by mistake, please notify the sender immediately, delete it and do not copy it to anyone else.

We have checked this email and its attachments for viruses. But you should still check any attachment before opening it.

We may have to make this message and any reply to it public if asked to under the Freedom of Information Act, Data Protection Act or for litigation. Email messages and attachments sent to or from any Environment Agency address may also be accessed by someone other than the sender or recipient, for business purposes.

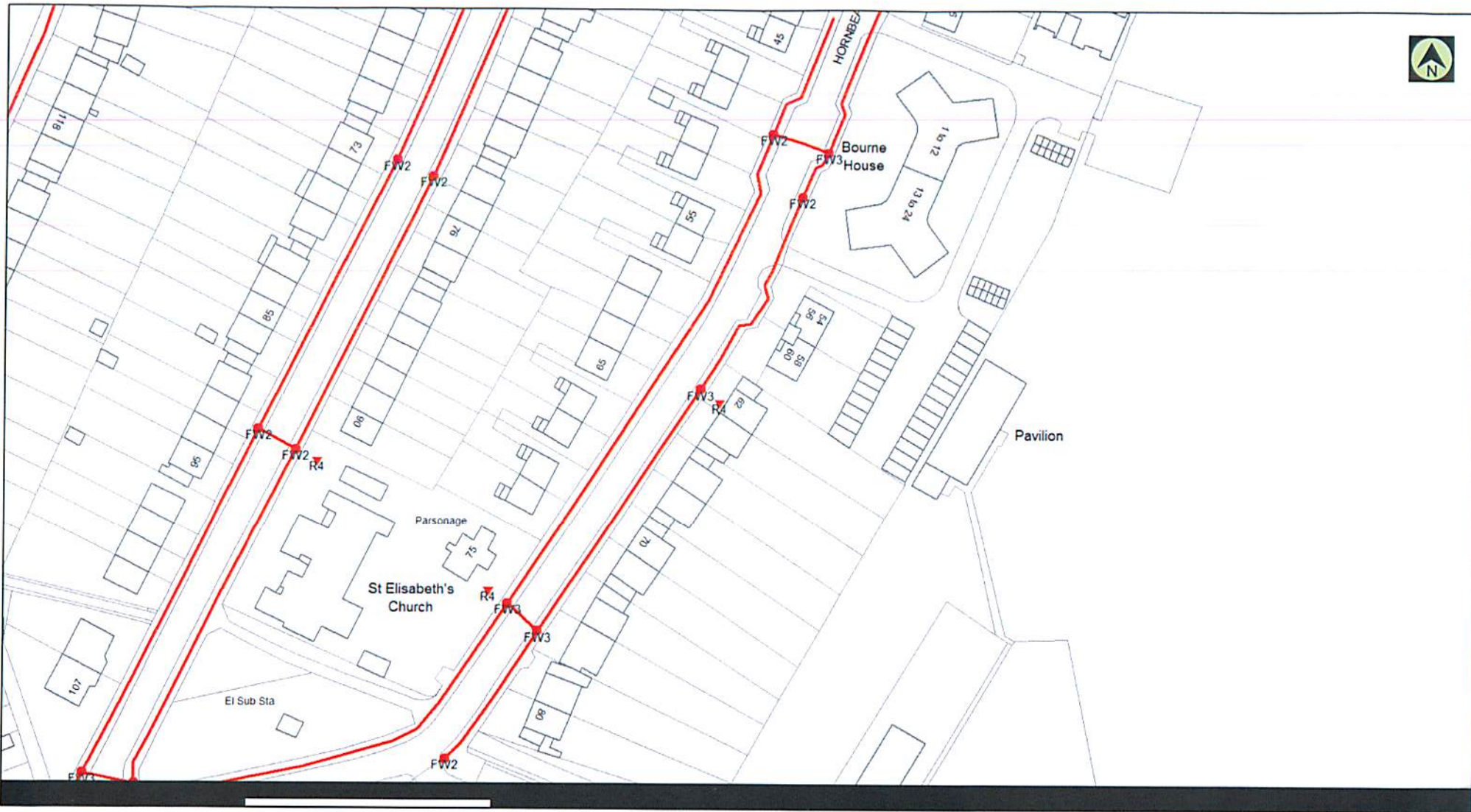

(c) Crown Copyright and database rights 2011 Ordnance Survey 100019209

Date: 24/10/13

Scale: 1:1083

Map Centre: 541907.8,193144.8

Data updated: 25/08/13

Telecoms Plan A4

Important information - please read

The purpose of this plan is to identify Virgin Media apparatus. We have tried to make it as accurate as possible but we cannot warrant its accuracy. In addition, we caution that within Virgin Media apparatus there may be instances where main voltage power cables have been placed inside green, rather than black ducting. Further details can be found using the 'Affected Postcodes.pdf', which can be downloaded from this website.

Therefore, you must not rely solely on this plan if you are carrying out any excavation or other works in the vicinity of Virgin Media apparatus. The actual position of any underground service must be verified by cable detection equipment, etc. and established on site before any mechanical plant is used. Accordingly, unless it is due to the negligence of Virgin Media, its employees or agents, Virgin Media will not have any liability for any omissions or inaccuracies in the plan or for any loss or damage caused or arising from the use of and/or any reliance on the plan.

This plan is produced by Virgin Media Limited from Ordnance Survey © Crown Copyright 100019209

Duct, Trench



Chamber



Cabinet



agreenhalgh@pellings.co.uk



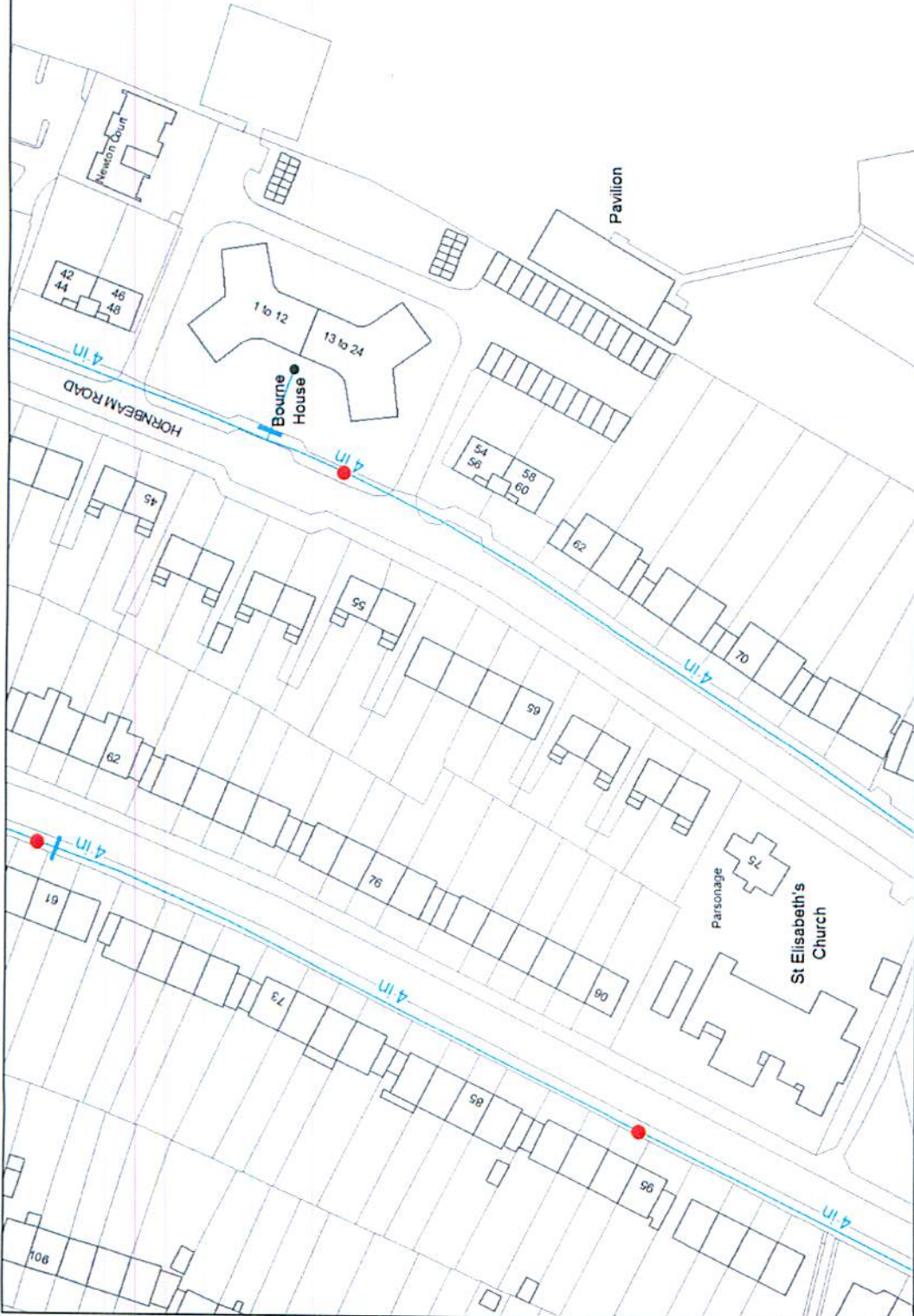

(c) Crown Copyright and database rights 2012 Ordnance Survey 100019345 Date: 23/10/13 Scale: 1:1083 Map Centre: 541923.8, 193163.7 Data updated: 16/08/13 Clean Water Plan A4

Based on the Ordnance Survey Map with the sanction of the Controller of the H.M. Stationary Office License Number:- 100019345. This map is to be used for the purposes of viewing the location of Thames Water plant only. Any other uses of the map data or further copies are not permitted. The position of the apparatus shown on this plan is given without obligation and warranty, and the accuracy cannot be guaranteed. This information is valid for the date printed. Service pipes are not shown but their presence should be anticipated. No liability of any kind whatsoever is accepted by Thames Water for any error or omission. The actual position of mains and services must be verified on site before any works are undertaken.

Water Main		Meter	
Private Water		Valve	
Proposed Water		Hydrant	
Abandoned Asset		End Item	

agreenhalgh@pellings.co.uk





(c) Crown Copyright and database rights 2012 Ordnance Survey 100019345  
 Scale: 1:1083  
 Map Centre: 541923.8, 193163.7  
 Date: 23/10/13  
 Data updated: 16/08/13  
 Wastewater Plan A4

agreenhalgh@pellings.co.uk

	Foul Sewer
	Surface Sewer
	Combined Sewer
	Abandoned Sewer
	Pressure Main
	Private Asset (Colour denotes effluent type)
	Proposed Asset (Colour denotes effluent type)
	Foul Manhole
	Surface Manhole
	Combined Manhole
	Abandoned Manhole
	Other Manhole
	End Item
	S104 Boundary

Based on the Ordnance Survey Map with the sanction of the Controller of H.M. Stationary Office License Number:- 100019345. This map is to be used for the purposes of viewing the location of Thames Water plant only. Any other uses of the map data or further copies are not permitted. The position of the apparatus shown on this plan is given without obligation and warranty, and the accuracy cannot be guaranteed. This information is valid for the date printed. Service pipes are not shown but their presence should be anticipated. No liability of any kind whatsoever is accepted by Thames Water for any error or omission. The actual position of mains and services must be verified on site before any works are undertaken.



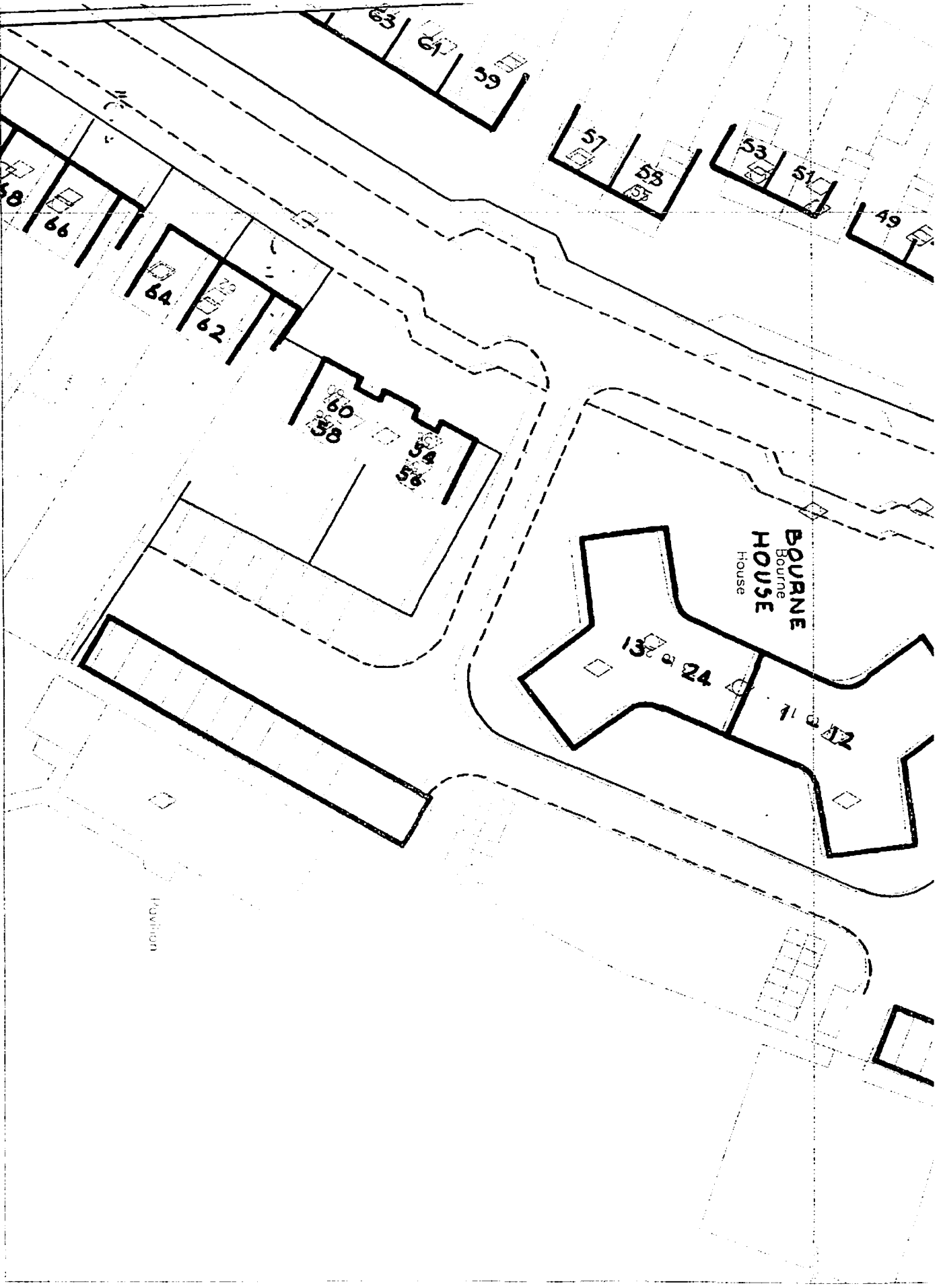

1. UK Power Networks does not warrant that the information provided to you is correct. You rely upon it at your own risk.
2. UK Power Networks does not exclude or limit its liability if it causes the death of any person or causes personal injury to a person where such death or personal

ADVICE TO CONTRACTORS ON AVOIDING DANGER FROM BURIED ELECTRICITY CABLES.

1) Do have cable drawings with you on site and check them before you start the

## Appendix E

### **Information on Possible Contamination**

Information on possible contamination has been forwarded by Epping Forest District Council by way of email of 22nd May 2013, giving information on potential contamination across all the primary sites.

This clarifies possible ground contamination derived from asbestos, made ground, hydrocarbons, petroleum hydrocarbons and the like.

It is likely that any Planning Consent will carry a Condition that all contamination issues are to be remediated.

Accordingly, we recommend that initial site investigation is undertaken for all sites that move forward to Planning Applications.

## Appendix F

Cost Build-up

Gross Internal floor area	m2	ft2
Affordable Flat Units	0	0
Allowance for communal space @ 20%	0	0
Affordable House Units	186	2,002
<b>TOTAL GIA</b>	<b>186</b>	<b>2,002</b>

Item	Element	Qty Unit	Rate £/unit	Total £
<b>1.0 Demolition</b>				
1.1	Demolition	299 m <sup>2</sup>	50	14,972
2.2	Site clearance	345 m <sup>2</sup>	10	3,451
1.2	Allowance for removal of asbestos	25 No	800	20,000
	<b>Sub-total</b>		<b>say</b>	<b>40,000</b>
<b>2.0 Affordable Flat units (xx nr. units)</b>				
2.1	Flats Private areas	0 m <sup>2</sup>	1,350	0
2.2	Flats communal areas (20% allowed)	0 m <sup>2</sup>	900	0
	<b>Sub-total</b>		<b>say</b>	<b>0</b>
<b>3.0 Affordable House units (02 nr. units)</b>				
3.1	House areas	186 m <sup>2</sup>	1,250	233,000
	<b>Sub-total</b>		<b>say</b>	<b>230,000</b>
<b>4.0 Abnormals / E/o and External Works</b>				
4.1	Private gardens (incl. fencing)	254 m <sup>2</sup>	40	10,000
4.2	Communal Gardens	83 m <sup>2</sup>	30	2,000
4.3	Access road, parking and turning	200 m <sup>2</sup>	65	13,000
4.4	Pedestrian paving	0 m <sup>2</sup>	50	Incl.
4.5	Cross over / highways adaptations	4 item	2,000	8,000
4.6	Allowance for contaminated ground	0 item		Excl.
4.7	Boundary treatment (fencing/walls)	107 m	160	17,000
4.8	Allowance for achieving CfSh Level 3	2 nr	4,500	9,000
	<b>Sub-total</b>		<b>say</b>	<b>60,000</b>
		£/m2	£/ft2	
<b>INDICATIVE CONSTRUCTION COST</b>				<b>330,000</b>
CONTINGENCY @ 5%				20,000
CONTRACTORS DESIGN FEES @ 8%				28,000
PRELIMS AND OVERHEADS AT 15%				49,500
<b>TOTAL INDICATIVE CONSTRUCTION COST</b>				<b>427,500</b>

**Clarifications and Assumptions**

Estimate based on Pellings Feasibility drawings and standard ETG specifications  
 GIA is approximate due to early stage of design  
 Costs are based on a Q3 2014 start on site  
 Costs are based on a Single Stage Competitive D&B procurement route  
 Costs are based on a Contractor 'best programme' contract period  
 All units assumed to achieve Code for sustainable Homes Level 3  
 It is assumed that a traditional construction (concrete strip foundations, brick/block walls, timber floor structure, sloped tiled roofs) will be used  
 Contractors design fees are based upon appointment with planning consent under JCT D&B contract  
 Assumed no Party Wall or Rights of Lights issues

**Exclusions**

Clients professional fees (including statutory fees)  
 VAT  
 Hazardous material removal  
 Excludes any off-site works  
 Provision of loose fittings and furnishings  
 Costs of compliance of any conditions imposed by TFL or other statutory bodies  
 Costs of Section 106, S108, S278 Agreement(s) or Community Infrastructure Levy charges